



BM30NT & BM30 Non-Metallic Inlets

Assembly Instructions for SmartPlug Boatside Inlet

For questions, comments or concerns please call 206-285-2990 or email at info@smartplug.com

- Ruler/Measuring Tape
- #2 Phillips Screwdriver
- Wire Cutters
- Scissors



Tools Needed

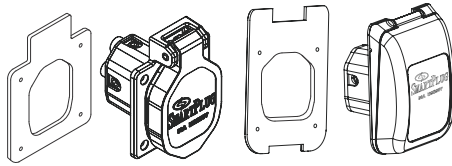

BM30NT
Stainless Steel

BM30
Non-Metallic

SmartPlug offers two types of inlets. These include stainless steel and non-metallic. The only difference between these products are the mounting flange and lids. The electrical components and mounting hole layout are the same for both inlets.

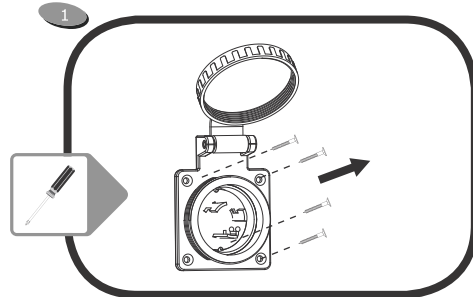

Remove old inlet's four mounting screws and pull out of boat. If the old inlet has a rear enclosure, loosen the strain relief clamp and remove it to access the wire connections.

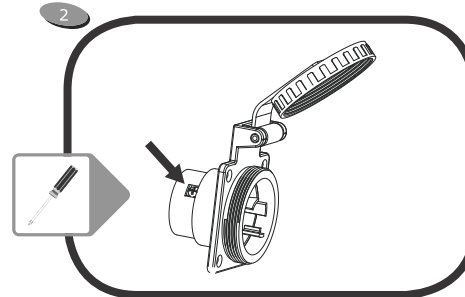

Loosen the screws to remove boat wires from the old inlet.

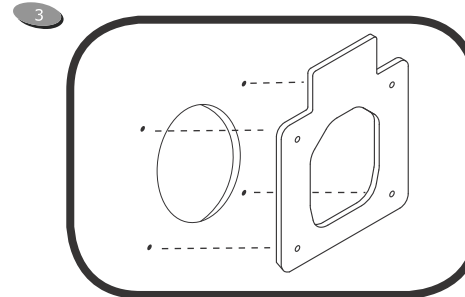

Test your new SmartPlug inlet for proper fit and hole alignment (some installations may require the hole to be modified to accept the new inlet) Please install the rear mounting gasket prior connecting wires to inlet.

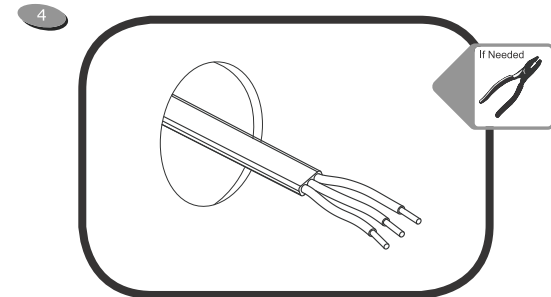

Examine the boat's internal wiring. Make sure the wire is clean and in good condition. If the wire is not bright copper cut it back until clean wire is exposed.

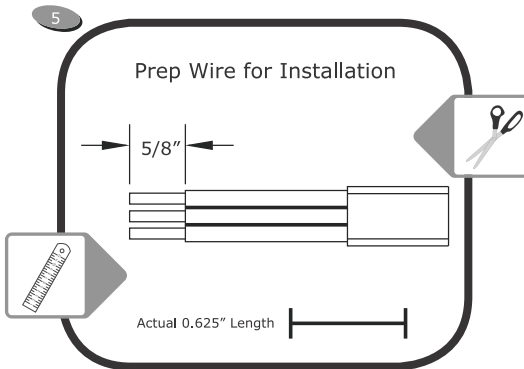

Strip the wire insulation back 5/8". Make sure the wire is clean and bright copper. Cut back wire until bright copper is exposed if wire is dirty.

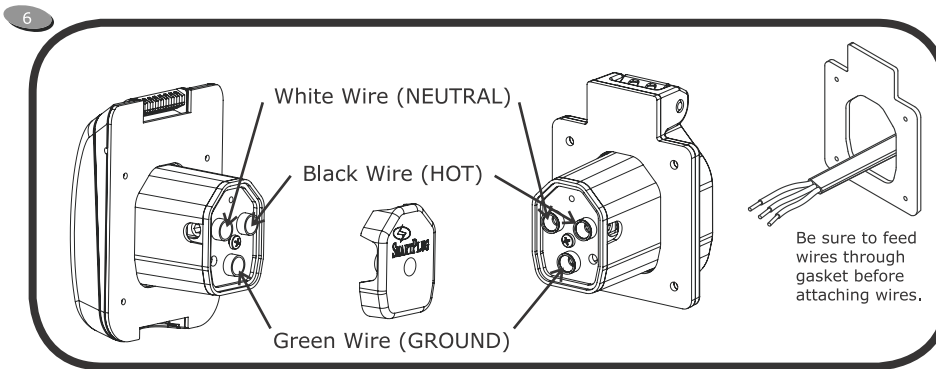

Remove plastic strain relief component from the back of the inlet and set aside. Loosen set screws. Twist bare copper wire strands into a tight and straight configuration. Insert the bare wires into the corresponding color-coded wire terminals.

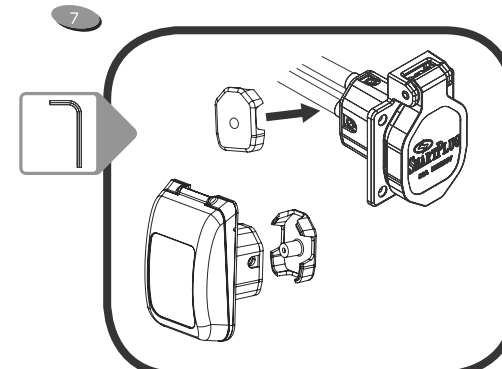

Make sure the wire insulation is butted up to the corresponding color-coded wire guide. Tighten set screw after each wire is inserted. Make sure there is no wire insulation inside the terminal clamp(s). Torque spec. 20 in/lb. Test wires by pulling on them to make sure they are secured.

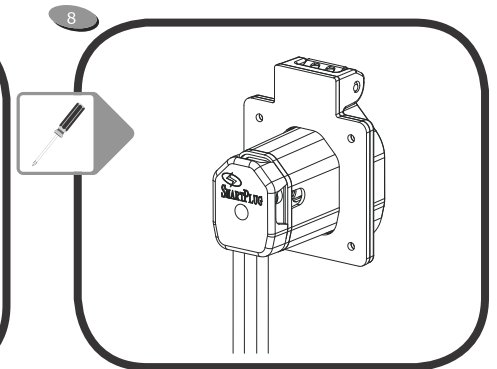

NOTE: If your installation requires using the strain relief component, bend all 3 wires flat so that they can be routed out of one or more of the guides in the strain relief as shown. Screw strain relief onto back of inlet.

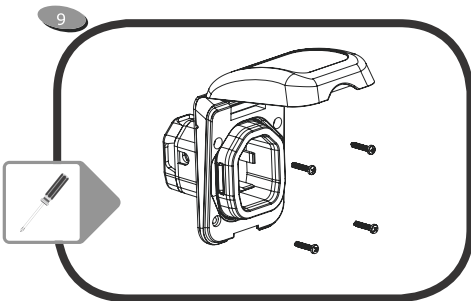

Reposition the new SmartPlug inlet in the boat and mount with the original four screws from the old inlet. Use #10 screws if new ones are required.

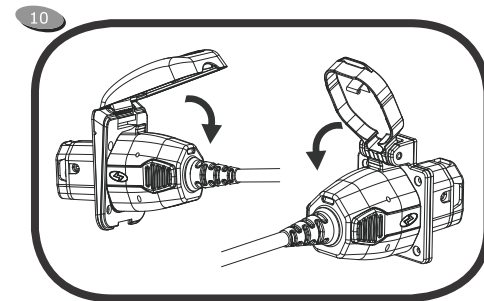

Insert plug into the inlet and press down on the inlet cover.

Materials Included

